

# HOUSEHOLD FOOD WASTE DRYER

Model\_ CT-K65

## Features



**For a Small Amount**  
(LED Color : Blue)

Use when the food waste is less than 500g.  
[Around 1-2 Times of Sink Filter]  
(Switching to Auto Breeze Mode after 8 Hours of Operation)



**For a Large Amount**  
(LED Color : Blue)

Use when the food waste is ranging from 500g to 1,000g.  
[Around 3-4 Times of Sink Filter]  
(Switching to Auto Breeze Mode after 12 Hours of Operation)

**Far-Infrared Radiation Lamp (LED Color : Blue)**  
Emits the Far-Infrared Radiation and Automatically Switches On and Off

**Life Cycle of Filter : 12 months**



## Specifications

<b>Model</b>	CT-K65
<b>Color</b>	Red, White
<b>Dimensions</b>	270mm(W) X 360mm(L) X 380mm(H)
<b>Method of Treatment</b>	Far-Infrared Radiation Sterilization & Drying
<b>Drying Time</b>	8h per Once
<b>Working Capacity</b>	6.5kg/day Maximum Capacity
<b>Rate of Reduction</b>	Maximum 90% of Reduction
<b>Targets</b>	Rice, Noodles, Bread, Cheese, Fish Bones and Other Ordinary Food Wastes
<b>Voltage</b>	220V/60Hz
<b>Power Consumption</b>	42w/h
<b>Weight</b>	11.5kg
<b>Regular Inspection</b>	Replace Filter Once per Year (Recommended)
<b>Use</b>	Household and Office Use

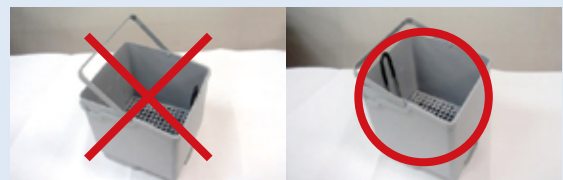

\*Note the Direction of Handle on the Basket